

# AutoFlow™



## A U T O M A T I C R E V O L V I N G D O O R



Horton Automatics' AutoFlow™ automatic revolving doors are energy efficient and offer easy, hands free operation.

SERIES 9300



### Innovative Features and Economical Performance

The **AutoFlow™** automatic revolving door is designed for use in hotels, hospitals, airports, banks, office buildings and similar applications.

**AutoFlow™** doors feature motion detectors at each opening that start rotation on user approach. A reduced speed feature slows door rotation to allow easy access in larger doors for wheelchairs, strollers and large parcels along with four field programmable voice prompts.

The microprocessor control provides wireless remote door speed adjustment and set up. A self-diagnostic display makes service and maintenance easy.

The solid-state voice module that alerts pedestrians is included for both reduced speed and resume speed conditions. In the event of power failure, the doors allow easy manual operation.

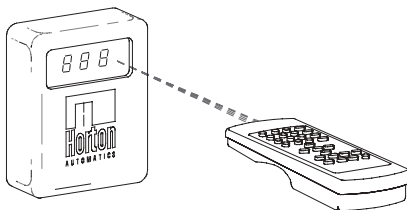

Exclusive wireless remote for setup and adjustment

Horton has the largest factory trained and certified distribution force to install, service and maintain your doors anywhere in the world.

### Standard Features:

- ▶ Standard diameters from 8' to 12'
- ▶ Round or Segmented™ drum design
- ▶ Curved tempered or laminated wall glass
- ▶ Bookfold collapsing hardware
- ▶ Flexible design
- ▶ Quick delivery on standard finishes
- ▶ Safety edges
- ▶ Bump-To-Idle™ safety
- ▶ Activating sensors
- ▶ Medium stile

### Specifier Options:

- ▶ Finishes (Anodized aluminum, paint, metal clad, wood)
- ▶ Special diameters and heights
- ▶ Aluminum roof panels
- ▶ Ceiling lights
- ▶ Glass ceiling
- ▶ Safety features VistaStop™ and FootGuard™
- ▶ AutoLock™ - automatic after-hours locking
- ▶ Magnetic breakaway for high wind conditions
- ▶ EntryGuard™ - late entry protection



# AutoFlow™

revolving doors are available with a variety of standard and optional features and diameters. Horton doors easily accommodate a full array of design, traffic and installation needs.

## Segmented™ Drum

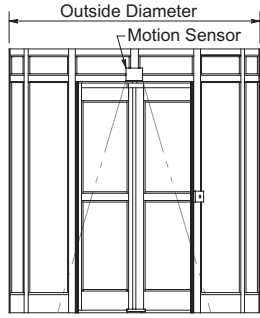

Elevation & Floor Plan

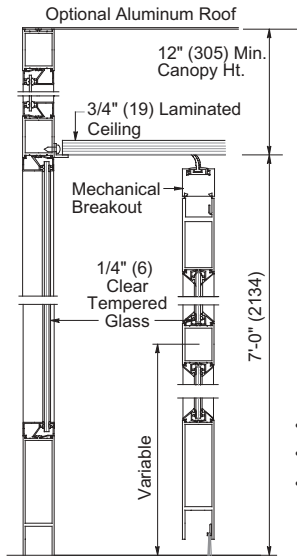

Vertical Section

**Standard Segmented™ Drum Dimensions**

Inside Diameter	Entry - 3 Wing	Entry - 4 Wing
8'-0" (2438)	3'-4 3/4" (1035)	5'-3 15/16" (1624)
9'-0" (2743)	3'-10 3/4" (1187)	6'-3/4" (1848)
10'-0" (3050)	4'-4 3/4" (1340)	6'-9 1/24" (2070)
12'-0" (3658)	4'-4 3/4" (1340)	8'-3" (2515)

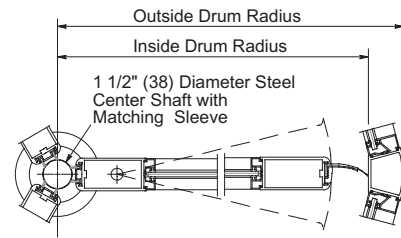

- Breakaway available with optional magnetic lock.
- Mini Grands (12' 0" Dia.) have full safety.
- Optional Round Canopy on Segmented™ drum enclosure.

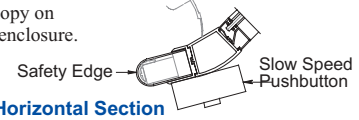

Horizontal Section

## Round Drum

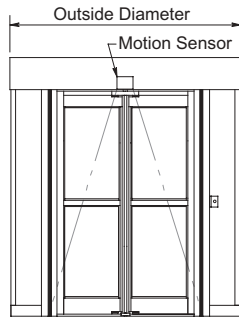

Elevation & Floor Plan

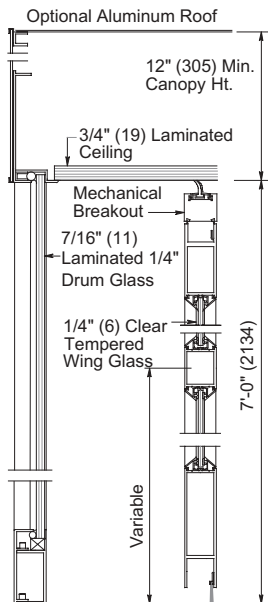

Vertical Section

**Standard Round Drum Dimensions**

Inside Diameter	Entry - 3 Wing	Entry - 4 Wing
8'-0" (2438)	3'-7 3/8" (1102)	5'-4 5/16" (1633)
9'-0" (2743)	4'-1 3/8" (1254)	6'-0 13/16" (1849)
10'-0" (3050)	4'-7 3/8" (1406)	6'-9 5/16" (2065)
12'-0" (3658)	5'-7 3/8" (1711)	8'-2 1/4" (2495)

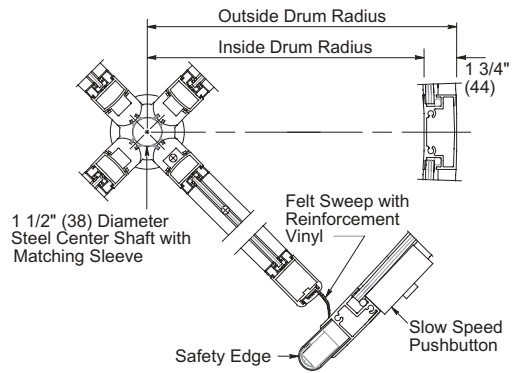

- Breakaway available with optional magnetic lock.
- 1/4 (6) Tempered Glass available for Drum and up to 1" (25) Insulated Glass available for both Wings and Drum

Horizontal Section



4242 Baldwin Boulevard  
Corpus Christi,  
Texas, U.S.A. 78405-3399  
Tel: 800-531-3111, 361-888-5591  
Fax: 800-531-3108, 361-888-6510  
[www.hortondoors.com](http://www.hortondoors.com)

**Horton Automatics, Ltd.**  
Unit A, Hortonwood 31  
Telford, Shropshire, England TF1-7YZ  
Tel: 01952 670169, Fax: 0192 670181  
International Tel: ++44-1952-670169  
International Fax: ++44-1952-670181



**Form F502**  
© 2003 Horton Automatics  
Printed in U.S.A.

Horton Automatics reserves the right to alter its product and specifications without notice.